

CDH-R Series

Dimensions and Land Patterns. (UNIT: mm)

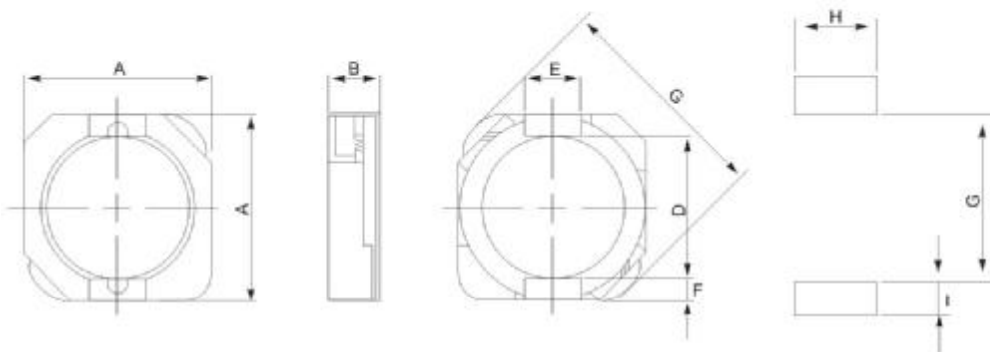

Applications:

Notebook, Desktop, Modem equipment, LCD
 ,OA equipment, other electronic equipment

TYPE	A(max)	B(max)	C(max)	D	E	F	G	H	I
CDH103R	10.50	3.10	13.50	7.70	3.00	1.20	7.30	3.20	1.60
CDH104R	10.50	4.00	13.50	7.70	3.00	1.20	7.30	3.20	1.60
CDH105R	10.50	5.10	13.50	7.70	3.00	1.20	7.30	3.20	1.60

SMD POWER INDUCTORS

TYPE: CDH104R, CDH105R

Parts No.	L (H)	CDH103R		CDH104R		CDH105R	
		D.C.R(Ω): MAX.	Rated Current (A)	D.C.R(Ω): MAX.	Rated Current (A)	D.C.R(Ω): MAX.	Rated Current (A)
1R2	1.2u	12m	4.80	12m	5.40	12.00m	8.30
1R5	1.5u	13m	4.60	14m	5.20	14.00m	8.30
1R8	1.8u	14m	4.50	15.5m	5.05	15.00m	7.85
2R2	2.2u	16m	4.30	17m	4.95	16.00m	7.50
2R7	2.7u	18m	4.10	19.5m	4.50	18.20m	7.10
3R3	3.3u	20m	3.92	22m	4.35	19.50m	6.50
3R9	3.9u	22m	3.76	26m	4.05	22.50m	6.00
4R7	4.7u	27m	3.55	30m	3.90	28.00m	5.50
5R6	5.6u	31m	3.30	33m	3.80	30.00m	4.50
6R8	6.8u	36m	3.10	42m	3.70	36.00m	4.90
8R2	8.2u	42m	3.00	53m	3.45	45.00m	4.55
100	10u	52m	2.80	60m	3.15	51.00m	4.00
150	15u	62m	2.10	78m	2.90	57.00m	3.30
180	18u	78m	1.90	92m	2.75	59.00m	3.10
220	22u	91m	1.80	107m	2.50	82.00m	2.90
330	33u	150m	1.53	133m	2.00	95.00m	2.60
470	47u	208m	1.34	241m	1.80	183.00m	2.00
560	56u	228m	1.19	260m	1.62	205.00m	1.80
680	68u	289m	1.13	338m	1.35	234.00m	1.60
820	82u	312m	1.04	384m	1.26	247.00m	1.40
101	100u	377m	960m	429m	1.17	325.00m	1.35

※ 测试条件: L≤8.2uH 测试频率100KHz / 0.25V, (N±30%);

L>8.2uH 测试频率1KHz / 0.25V, (M±20%);

※ 测试仪表: HP4291B、502BC、CH1062.