

Dimensions and Land Patterns. (UNIT: mm)

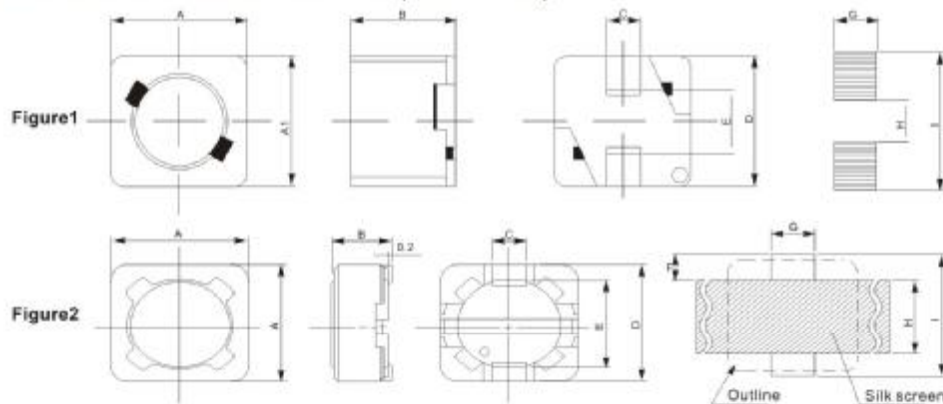

Applications: Notebook, Desktop, Modem equipment, LCD, OA equipment, other electronic equipment

TYPE	A(Max)	A ₁ (Max)	B(Max)	C	D	E	F	G	H	I
CDH62	6.50	6.20	3.00	1.50	6.00	2.80		2.50	4.00	8.10
CDH64	6.50	6.20	5.00	1.50	6.00	2.80		2.50	4.00	8.10
CDH73	7.50		3.40	1.80	7.20	5.40	1.50	2.20	4.80	7.80
CDH74	7.50		4.50	1.80	7.20	5.40	1.50	2.20	4.80	7.80

SMD POWER INDUCTORS

TYPE: CDH62, CDH64, CDH73, CDH74

Parts No.	L (H)	CDH62		CDH64		CDH73		CDH74	
		D.C.R(Ω): MAX.	Rated Current (A)	D.C.R(Ω): MAX.	Rated Current (A)	D.C.R(Ω): MAX.	Rated Current (A)	D.C.R(Ω): MAX.	Rated Current (A)
1R0	1.0u	30m	2.60	23m	2.80	40.3m	4.00	20.0m	5.00
1R5	1.5u	38m	2.49	33m	2.62	47.6m	3.75	20.8m	4.60
2R2	2.2u	50m	2.30	48m	2.49	55.3m	3.50	24.7m	4.40
2R7	2.7u	61m	2.16	52m	2.32	51.7m	3.30	26.7m	4.00
3R3	3.3u	68m	1.94	68m	2.15	49.5m	3.10	30.2m	3.70
3R9	3.9u	73m	1.77	73m	1.86	46.6m	2.90	32.5m	3.30
4R7	4.7u	80m	1.63	77m	1.70	42.9m	2.70	39m	3.05
5R6	5.6u	96m	1.40	89m	1.58	63.7m	2.40	42m	2.98
6R8	6.8u	100m	1.33	94m	1.44	85.6m	2.15	45.5m	2.90
8R2	8.2u	100m	1.14	96m	1.40	102.3m	1.88	52m	2.50
100	10u	150m	1.10	120m	1.35	119.6m	1.70	65m	2.00
120	12u	200m	1.00	130m	1.22	136.5m	1.60	70.2m	1.90
150	15u	230m	900m	180m	1.11	123.5m	1.40	78m	1.70
180	18u	270m	800m	240m	1.02	193.7m	1.30	110.5m	1.55
220	22u	340m	740m	270m	910m	195m	1.20	126.1m	1.40
270	27u	380m	660m	300m	820m	227.5m	1.00	140.4m	1.30
330	33u	450m	590m	330m	740m	260m	970m	176.8m	1.10
390	39u	490m	540m	370m	690m	273m	940m	226.2m	1.03
470	47u	690m	500m	520m	620m	312m	900m	260m	900m
560	56u	780m	460m	560m	580m	507m	800m	286m	820m
680	68u	1.07	420m	630m	510m	585m	720m	338m	774m
820	82u	1.21	380m	710m	460m	676m	600m	364m	700m
101	100u	1.39	340m	1.03	420m	728m	540m	403m	680m

※ 测试条件: L≤8.2uH 测试频率100KHz / 0.25V, (N±30%);

L>8.2uH 测试频率1KHz / 0.25V, (M±20%);

※ 测试仪表: HP4291B、502BC、CH1062.