

CDH Series

Dimensions and Land Patterns. (UNIT: mm)

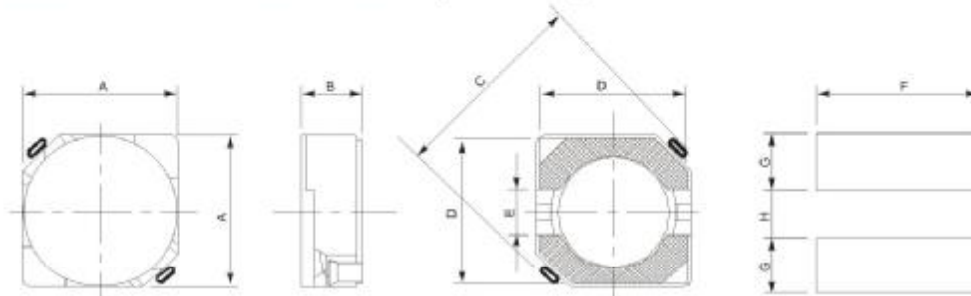

Applications: Ideal use in variety of DC-DC converter inductor applications.
Mobile Phone,DSC,DVC,
PDA,MP3,LCD panel,Mobile Set Etc.

TYPE	A(max)	B (max)	C(max)	D	E	F	G	H
CDH2D18	3.00	2.00	4.90	3.00	1.10	3.50	1.40	1.10
CDH3D16	4.00	1.80	5.90	3.50	1.30	4.30	1.65	1.30
CDH3D28	4.00	3.00	5.90	3.50	1.30	4.30	1.65	1.30
CDH4D18	5.00	2.00	6.90	4.50	1.50	5.30	1.90	1.50
CDH4D28	5.00	3.00	6.90	4.50	1.50	5.30	1.90	1.50
CDH5D18	6.00	2.00	8.20	5.50	2.00	6.30	2.15	2.00
CDH5D28	6.00	3.00	8.20	5.50	2.00	6.30	2.15	2.00
CDH6D28	7.00	3.00	9.50	6.50	2.00	7.30	2.65	2.00
CDH6D38	7.00	4.00	9.50	6.50	2.00	7.30	2.65	2.00

SMD POWER INDUCTORS

TYPE: CDH2D18, CDH3D16, CDH3D28

Parts No.	L (H)	CDH2D18		CDH3D16		CDH3D28	
		D.C.R(Ω): MAX.	Rated Current (A)	D.C.R(Ω): MAX.	Rated Current (A)	D.C.R(Ω): MAX.	Rated Current (A)
1R0	1.0u	26m	1.55	45.50m	1.47	32m	2.40
1R5	1.5u	31m	1.45	52.00m	1.45	40m	2.28
1R8	1.8u	38m	1.20	64.00m	1.38	47m	2.20
2R2	2.2u	43m	1.00	72.00m	1.20	55m	2.10
2R7	2.7u	56m	900m	75.00m	1.18	63m	1.98
3R0	3.0u	64m	820m	85.00m	1.10	72m	1.85
3R3	3.3u	72m	785m	95.00m	1.00	80m	1.77
3R9	3.9u	80m	720m	105.00m	900m	89m	1.62
4R7	4.7u	100m	670m	119.60m	822m	103m	1.49
5R6	5.6u	120m	620m	170.00m	730m	120m	1.24
6R8	6.8u	157m	555m	190.00m	621m	133m	1.14
8R2	8.2u	189m	475m	210m	550m	145m	1.05
100	10u	201m	445m	247m	500m	182m	955
120	12u	228m	415m	295m	450m	213m	900m
150	15u	277m	380m	416m	410m	283m	820m
180	18u	332m	324m	430m	400m	335m	740m
220	22u	502m	265m	546m	370m	411m	630m
270	27u	657m	234m	675m	320m	481m	580m
330	33u	741	214m	871m	278m	527m	520m
390	39u	1.12	180m	962m	260m	600m	480m

※ 测试条件: L≤8.2uH 测试频率100KHz / 0.25V, (N±30%);

L>8.2uH 测试频率1KHz / 0.25V, (M±20%);

※ 测试仪表: HP4291B、502BC、CH1062。

SMD POWER INDUCTORS

TYPE:CDH4D18, CDH4D28, CDH5D18

Parts No.	L (H)	CDH4D18		CDH4D28		CDH5D18	
		D.C.R(Ω): MAX.	Rated Current (A)	D.C.R(Ω): MAX.	Rated Current (A)	D.C.R(Ω): MAX.	Rated Current (A)
1R0	1.0u	28.60m	1.80	25.74m	2.70	17.68m	3.00
1R5	1.5u	45.50m	1.45	27.3m	2.40	23.40m	2.30
1R8	1.8u	48.50m	1.43	30.6m	2.10	29.20m	2.20
2R2	2.2u	52.00m	1.40	33.8m	1.80	36.40m	2.10
2R7	2.7u	58.50m	1.30	39.0m	1.70	40.30m	2.00
3R3	3.3u	62.40m	1.15	43.5m	1.60	49.40m	1.83
3R9	3.9u	65.00m	900m	48.1m	1.50	57.50m	1.72
4R7	4.7u	78.00m	860m	52m	1.35	65.00m	1.60
5R6	5.6u	98.80m	820m	58.5m	1.21	72.80m	1.45
6R8	6.8u	143.00m	780m	88.4m	1.15	78.00m	1.31
8R2	8.2u	156.00m	700m	102.5m		96.20m	1.10
100	10u	158.60m	620m	119.6m	1.00	124.00m	1.04
120	12u	208m	570m	140.4m	840m	153.00m	950m
150	15u	247m	500m	156m	752m	196.00m	850m
180	18u	253m	450m	197m	735m	210.00m	790m
220	22u	260m	420m	247m	700m	290.00m	700m
270	27u	398m	380m	299m	585m	330.00m	655m
330	33u	546m	335m	325m	570m	385.00m	585m
390	39u	585m	315m	351m	520m	520.00m	510m
470	47u			377m	510m		
560	56u	845m	295m	442m	500m	595.00m	480m
680	68u	910m	275m	468m	420m	665.00m	430m
750	75u	1.00	245m	546m	352m	840.00m	400m
820	82u	1.30	225m	780m	330m	978.00m	360m
101	100u	1.56	205m	858m	300m	1.20	325m
121	120u	2.10	185m	1.3	280m	1.30	295m
151	150u	2.34	155m	1.5	250m	1.61	270m
181	180u	2.60	145m	1.6	230m	2.05	245m
221	220u	3.38	140m	1.82	210m	2.29	225m
271	270u	4.03	135m	2.86	185m	2.99	200m
331	330u	4.56	130m	3.25	170m	3.51	185m
391	390u	5.07	125m	4.55	155m	4.16	155m
471	470u	5.46	120m	5.07	140m	4.81	150m
561	560u	8.19	112m	5.46	130m	5.20	140m

※ 测试条件: L≤8.2uH 测试频率100KHz / 0.25V, (N±30%);

L>8.2uH 测试频率1KHz / 0.25V, (M±20%);

※ 测试仪表: HP4291B、502BC、CH1062。

SMD POWER INDUCTORS

TYPE:CDH5D28, CDH6D28, CDH6D38

Parts No.	L (H)	CDH5D28		CDH6D28		CDH6D38	
		D.C.R(Ω): MAX.	Rated Current (A)	D.C.R(Ω): MAX.	Rated Current (A)	D.C.R(Ω): MAX.	Rated Current (A)
1R0	1.0u	15.60m	3.45	18.2m	3.60	19.5m	5.00
1R5	1.5u	19.20m	3.00	1.96m	3.53	21.2m	4.30
1R8	1.8u	22.10m	2.70	20.8m	3.45	23.4m	3.90
2R2	2.2u	24.70m	2.30	24.7m	3.15	26.7m	3.75
2R7	2.7u	28.60m	2.26	27.3m	2.84	28.6m	3.40
3R3	3.3u	32.50m	2.23	29.9m	2.80	33.8m	2.95
3R9	3.9u	35.00m	2.05m	32.5m	2.60	36.4m	2.90
4R7	4.7u	39.00m	1.90	40.3m	2.30	37.7m	2.88
5R6	5.6u	44.20m	1.76	45.5m	2.13	41.6m	2.61
6R8	6.8u	52.00m	1.63	46.8m	1.88	49.4m	2.39
8R2	8.2u	58.50m	1.50	55.9m	1.73	54.6m	2.07
100	10u	78.00m	1.30	75.4m	1.60	63.7m	2.00
120	12u	84.50m	1.20	80.6m	1.50	78.0m	1.94
150	15u	114.4m	1.10	89.7m	1.34	87.1m	1.60
180	18u	119.6m	1.00	93.6m	1.21	106.6m	1.44
220	22u	156.00m	890m	122.2m	1.10	113.1m	1.30
270	27u	188.50m	800m	131.3m	1.02	130.0m	1.20
330	33u	206.70m	730m	159.9m	918m	143.0m	1.07
390	39u	230.75m	690m	195m	835m	163.8m	1.00
470	47u	260m	610m	234m	745m	182m	950m
560	56u	338m	560m	273m	685m	221m	850m
680	68u	364m	505m	364m	607m	234m	750m
820	82u	416m	460m	403m	570m	324m	700m
101	100u	572m	415m	507m	520m	358m	630m
121	120u	676m	390m	676m	450m	442m	605m
151	150u	875m	360m	806m	410m	572m	513m
181	180u	1.05	305m	949m	380m	637m	486m
221	220u	1.30	285m	1.11	350m	936m	427m
271	270u	1.52	255m	1.56	310m	1.00	387m
331	330u	2.21	230m	1.70	285m	1.20	350m
391	390u	2.40	210m	1.95	253m	1.30	318m
471	470u	2.60	190m	2.73	230m	1.95	294m
561	560u	2.96	175m	2.99	220m	2.34	260m
681	680u	3.77	165m	3.51	193m	2.47	230m

※ 测试条件: $L \leq 8.2\mu\text{H}$ 测试频率100KHz / 0.25V, (N \pm 30%);

$L > 8.2\mu\text{H}$ 测试频率1KHz / 0.25V, (M \pm 20%);

※ 测试仪表: HP4291B、502BC、CH1062。