

## CDF-B Series

### Dimensions and Land Patterns. (UNIT: mm)

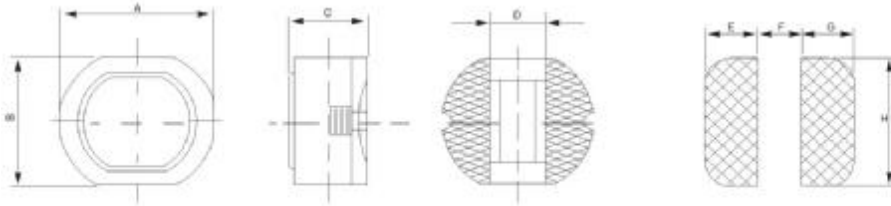

TYPE	A	B	C(Max)	D	E	F	G	H
CDF62B	6.2±0.30	5.6±0.30	3.50	2.20	2.40	1.80	2.40	6.00
CDF75B	7.8±0.30	7.0±0.30	4.80	2.50	3.50	2.00	3.50	7.50
CDF105B	10.0±0.40	9.0±0.40	5.50	3.20	4.50	2.50	4.50	9.50

Applications:

Notebook, Desktop, Modem equipment,  
LCD, OA equipment, other electronic  
equipment

## SMD POWER INDUCTORS

TYPE: CDF62B, CDF75B, CDF105B

Parts No.	L (H)	CDF62B		CDF75B		CDF105B	
		D.C.R(Ω): MAX.	Rated Current (A)	D.C.R(Ω): MAX.	Rated Current (A)	D.C.R(Ω): MAX.	Rated Current (A)
1R2	1.2u	8m	2.80	10m	4.30	6m	5.50
1R5	1.5u	13m	2.50	12m	3.70	7m	4.90
1R8	1.8u	19m	2.35	13.5m	3.10	8m	4.20
2R7	2.7u	26m	2.00	14m	2.70	11m	3.70
3R9	3.9u	31m	1.55	18m	2.60	13m	3.00
5R6	5.6u	39m	1.35	21m	2.25	15.5m	2.70
6R8	6.8u	44m	1.25	30m	2.00	18m	2.30
100	10u	60m	1.18	39m	1.80	22m	2.00
150	15u	94m	900m	60m	1.57	34m	1.70
220	22u	130m	720m	75m	1.23	43m	1.40
330	33u	176m	630m	109m	1.00	61m	1.15
470	47u	260m	490m	150m	810m	92m	940m
680	68u	426m	420m	241m	660m	120m	790m
101	100u	520m	340m	312m	585m	182m	660m
151	150u	1.00	300m	403m	420m	302m	500m
221	220u	1.22	240m	650m	350m	384m	450m
331	330u	2.02	200m	1.05	300m	559m	360m
471	470u	2.54	160m	1.30	260m	780m	300m
681	680u	3.74	140m	2.34	210m	1.07	240m
102	1.00m	5.72	110m	3.12	170m	1.59	200m

※ 测试条件: L≤8.2uH 测试频率100KHz / 0.25V, (N±30%);

L>8.2uH 测试频率1KHz / 0.25V, (M±20%);

※ 测试仪表: HP4291B, 502BC, CH1062.